

**Filling Capacity**

 at filling ratio 63 kg / 1:20 50 kg / 1:25 42 kg / 1:30
**Water Evaporation**

 filling ratio / steam heating - 10 bar saturated steam 1:30 160 l/h = 2,6l/min  
 evaporation depending on local conditions

**Drum**

 diameter x depth 1270 x 1000 mm  
 volume 1260 dm<sup>3</sup>
**Standard Version**

- |  |   |
|--|---|
| <ul style="list-style-type: none"> <li>- Cyclic loading at front with lifting door</li> <li>- Automatic, pneumatic unloading at the rear by lifting door</li> <li>- Recirculation system for optimal finish</li> <li>- Thermostatic-electronic temperature control of inlet- and exhaust air (SAT)</li> <li>- Touchscreen control</li> <li>- Automatic gas heating for natural gas</li> <li>- Drum of stainless steel</li> <li>- Control for automatic operation as single- resp. Installation unit</li> </ul> | <ul style="list-style-type: none"> <li>- Radial-diagonal air flow</li> <li>- Drum drive by friction wheel, reversible by means of V-belt and socket gear</li> <li>- Pedestal height 1000mm</li> <li>- Large lint bag</li> <li>- Colour: RAL 5018 turquoise blue</li> <li>- Electric supply: 3/N ~ 50Hz, 400/230 V</li> <li>- Easy maintenance and inner surface cleaning</li> <li>- Cool down system, time controlled</li> <li>- Machine equipped in accordance with relevant safety standards</li> </ul> |
|--|---|

**Special Version**

- |   |   |
|---|---|
| <ul style="list-style-type: none"> <li>- Automatic tilt-unloading at the rear, including firm gas supply connections, including gas supply control</li> <li>- Drum poly-coated</li> <li>- Teflon door seals (for mats)</li> <li>- Drum plates screwable/screwable teflon coated</li> <li>- Additional heat- and noise insulation</li> <li>- Sprinkler device</li> <li>- Thermost.-electric overdrying protection ÜS via infrared</li> </ul> | <ul style="list-style-type: none"> <li>- Special voltage, special frequency</li> <li>- CSA-, Nema/UL-regulation</li> <li>- Special finish</li> <li>- Special pedest heights: 1250mm, 1500mm, 1750mm, 2000mm</li> <li>- Tilting version-pedestal + 100 mm</li> <li>- inlet air from outside</li> <li>- Frequency converter for drum device</li> <li>- Preparation for central lint collection</li> </ul> |
|---|---|

**Accessories**

transport units for loading and unloading

**Connected Load and Consumption Rate**

	<b>Connected Load</b>	<b>Consumption</b>
Electric - without transport units	8,0 kW	6,8 kW
Natural gas Hi = 34,02 MJ/m <sup>3</sup> (HU = 9,45kWh/m <sup>3</sup> ) gas flow pressure 30-50 mbar	18,0 m <sup>3</sup> /h	13,5 m <sup>3</sup> /h
LPG gas Hi = 46,34 MJ/kg (HU = 12,9 kWh/kg) upon request gas flow pressure 50 mbar	13,2 kg/h	9,9 kg/h
Nominal heating capacity	170 kW	
Compressed air 6 bar, 6 charges/h suction capacity	250 l/h	200 l/h
Consumption depending on local conditions		

**Exhaust Air Rate**

Exhaust air rate with recirculation drying cycle in operation	1300-2500 m <sup>3</sup> /h
Exhaust air rate with aerate drying + cool down cycle max.	5000 m <sup>3</sup> /h
Counter pressure from local exhaust pipe max. permissible	3,0 mbar

**Packing**

pedestal dismantled	WxHxD ca.	2350x2500x2050mm
---------------------	-----------	------------------

**Weights**

Tumbler net	1500 kg
op. Weight approx.	1600 kg

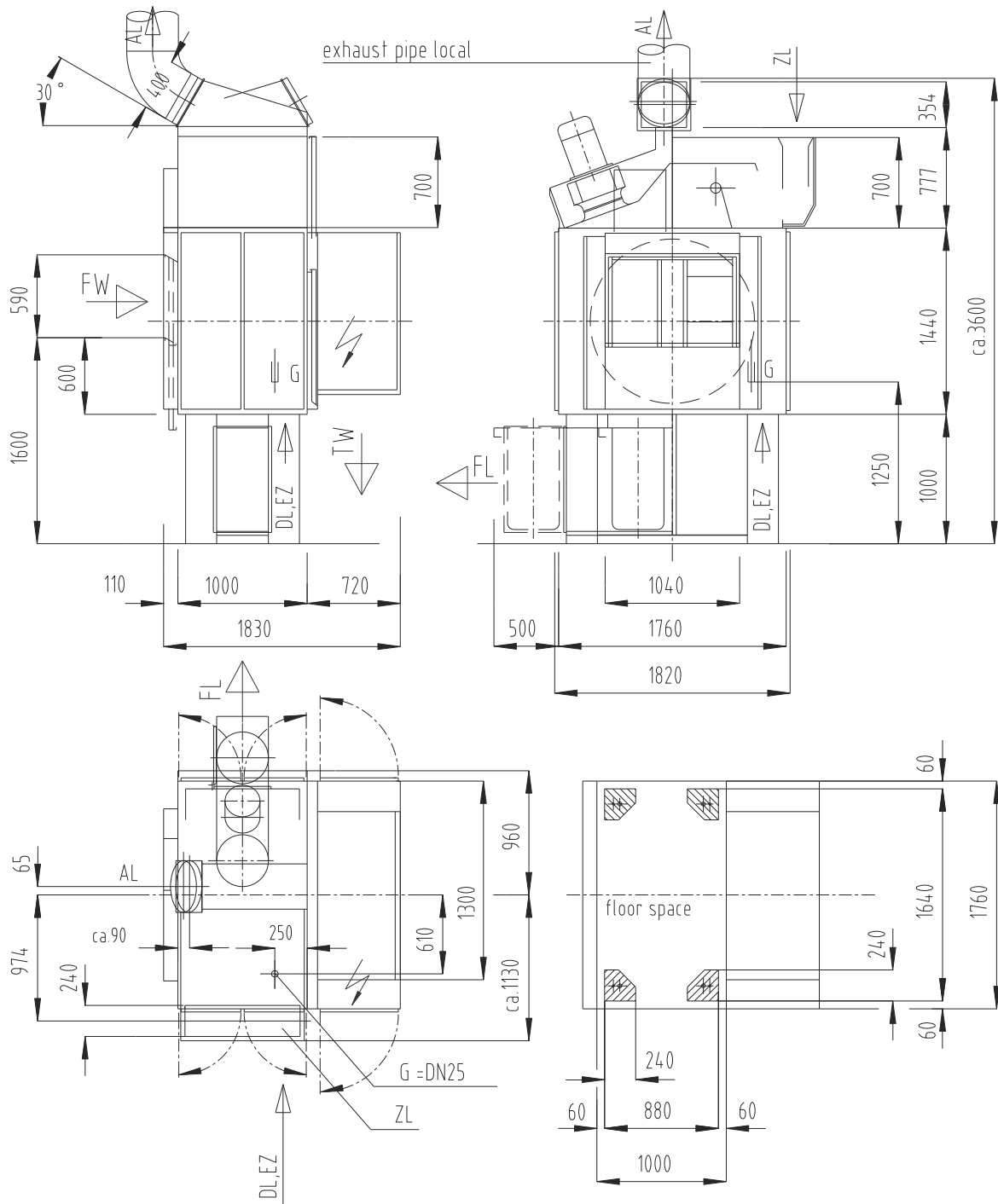

- FW = moist linen
- TW = dry linen
- AL = exhaust air DN 400
- ZL = inlet air
- DL = compressed air DN 6
- FL = lint removal
- EZ = electric supply
- G = gas supply DN25

- Entrance dimensions:
- Height ca. 2350 mm
  - Width ca. 2150 mm
  - Wall distance ca. 600 mm
  - Foundation load ea. Leg ca. 400 kg